

Model No.: **GP1604A**

<b>NO MERCURY ADDED</b>	
<b>Description</b>	: Alkaline Manganese 9V Battery
<b>Chemical System</b>	: Alkaline Manganese Dioxide
<b>Nominal Voltage</b>	: 9.0 Volts
<b>Nominal Dimensions</b>	: 25.5 (L)mm x 16.5 (W)mm x 47.5 (H)mm
<b>Operating Temp.</b>	: -20 - 60 °C , 65 % RH Max
<b>Storage Temp.</b>	: 15 - 25 °C , 45 - 75 % RH
<b>Terminal</b>	: Nickel plated miniature snap fasteners
<b>Jacket</b>	: Printed metal jacket
<b>Internal Connection</b>	: Welding
<b>Application</b>	: All electronics devices
<b>Nominal Weight</b>	: 47g
<b>Date Code</b>	: Unless otherwise specified, every battery will carry a 6 digits (MM-YYYY) expiry code.
<b>Special Feature</b>	: World class explosion proof
<b>Shelf Life</b>	: 5 years as below conditions

### Cross References:

GP	JIS	IEC	Eveready	Duracell
1604A	6LP3146	6LP3146	522	MN1604

### Electrical Characteristics

Test Items	Test Conditions 25 ± 2°C 60 ± 15%RH	Specification (Volt), min			
		3 months	1 year	3 years	5 years
OCV		9.30V	9.20V	9.00V	8.80V
CCV	47Ω, 0.3 s	8.00V	7.80V	7.50V	7.20V

### Discharge Capacity

Test Items	Test Conditions 25 ± 2°C 60 ± 15%RH (EV=End Voltage)	Specification (Hours), mean			
		3 months	1 year	3 years	5 years
Duration	270 Ω Intermittent 1 h/d EV=5.40V	20.0	19.7	18.2	16.2
	620 Ω Intermittent 2 h/d EV=5.40V	48.2	47.2	44.7	40.7
	10 kΩ background 24 h/d, 620 Ω 1 s/h pulse EV=7.50V	Specification (Days), mean			
		19.0	18.5	17.5	16.5*

\* Storage performance is estimated.

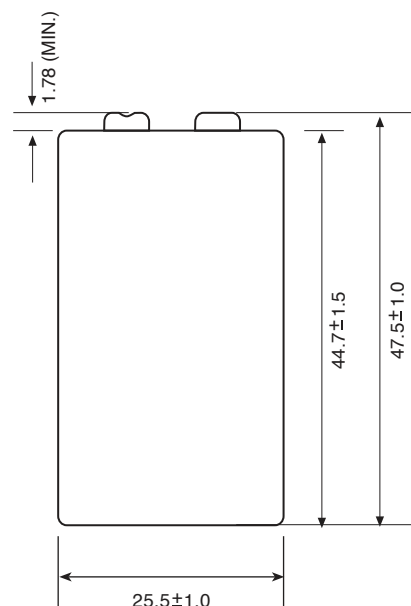
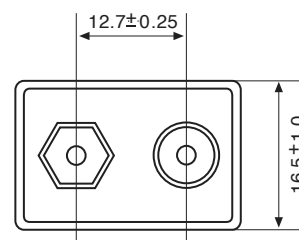

Unit : mm

The information (subject to change without prior notice) contained in this document is for reference only and should not be used as a basis for product guarantee or warranty. For applications other than those described here, please consult your nearest GP Sales and Marketing Office or Distributors.