

WWW.GEWISS.COM

GEWISS

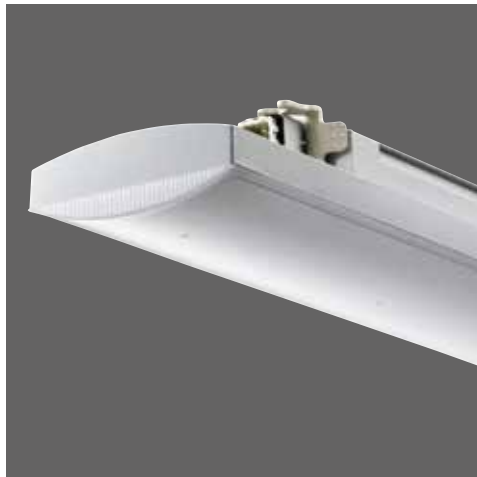



Table of Contents

- DomoticsPowerBuilding.pdf - page12653
- DomoticsPowerBuilding.pdf - page12664
- DomoticsPowerBuilding.pdf - page12675
- DomoticsPowerBuilding.pdf - page12686
- DomoticsPowerBuilding.pdf - page12697
- DomoticsPowerBuilding.pdf - page12708
- DomoticsPowerBuilding.pdf - page12719
- DomoticsPowerBuilding.pdf - page127210
- DomoticsPowerBuilding.pdf - page127311
- DomoticsPowerBuilding.pdf - page127412
- DomoticsPowerBuilding.pdf - page127513

24 SC

Flush mounting; surface or underfloor boxes

Wide range of surface-mounting and flush-mounting boxes for domestic ranges with high mechanical robustness and accessories supplied: dividers, junction elements, mortar-guard shield etc. Completing the range, the distribution outlet boxes for floor-mounting installations can be personalised in terms of capacity, external design finish, and internal fittings (they take both System range components and DIN rail devices).



Technical characteristics page 1273

UNDERFLOOR OUTLET BOXES

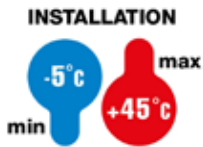

GWT
850°C

UNDERFLOOR OUTLET BOXES - WITH SUPPORTS POSITIONED VERTICALLY



GW 24 601

UNDERFLOOR OUTLET BOXES WITH HOLLOW LID - GLOW WIRE TEST 850° C



Code	Internal modularity	No. of supports	Outer dim. LxHxD (mm)	Pack Carton
GW 24 601	10 SYSTEM modules	2 supports with 5 System mod.	212x98x320	1
GW 24 602	20 SYSTEM modules	4 supports with 5 System mod.	364x98x320	1

CHARACTERISTICS: the supports are suitable for the insertion of plastic mobile dividers (energy/data) included.
The lid can be removed with the aid of a tool, and can be assembled on either side of the box.
The lid can be completed by inserting the same finish as used for the floor of the installation area.

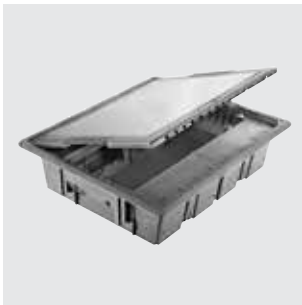

GW 24 612

UNDERFLOOR OUTLET BOXES WITH STAINLESS STEEL LID - GLOW WIRE TEST 850° C



Code	Internal modularity	No. of supports	Outer dim. LxHxD (mm)	Pack Carton
GW 24 611	10 SYSTEM modules	2 supports with 5 System mod.	212x98x320	1
GW 24 612	20 SYSTEM modules	4 supports with 5 System mod.	364x98x320	1

CHARACTERISTICS: the supports are suitable for the insertion of plastic mobile dividers (energy/data) included.
The lid can be removed with the aid of a tool, and can be assembled on either side of the box.
The lid has a stainless steel design surface finish.

UNDERFLOOR OUTLET BOXES - WITH SUPPORTS POSITIONED HORIZONTALLY



GW 24 606

UNDERFLOOR OUTLET BOXES WITH HOLLOW LID - GLOW WIRE TEST 850° C



Code	Internal modularity	No. of bases	No. of supports	Outer dim. LxHxD (mm)	Pack Carton
GW 24 606	16 SYSTEM modules	1 base	8 supports with 2 System mod.	212x98x320	1
GW 24 607	32 SYSTEM modules	2 bases	16 supports with 2 System mod.	364x98x320	1

CHARACTERISTICS: each base includes 8 snap-fit System supports.

The base is fixed with screws to the underfloor outlet box.

Plastic dividers (energy/data) are already included in the base.

The lid can be removed with the aid of a tool, and can be assembled on either side of the box.

The lid can be completed by inserting the same finish as used for the floor of the installation area.



GW 24 616

UNDERFLOOR OUTLET BOXES WITH STAINLESS STEEL LID - GLOW WIRE TEST 850° C



Code	Internal modularity	No. of bases	No. of supports	Outer dim. LxHxD (mm)	Pack Carton
GW 24 616	16 SYSTEM modules	1 base	8 supports with 2 System mod.	212x98x320	1
GW 24 617	32 SYSTEM modules	2 bases	16 supports with 2 System mod.	364x98x320	1

CHARACTERISTICS: each base includes 8 snap-fit System supports.

The base is fixed with screws to the underfloor outlet box.

Plastic dividers (energy/data) are already included in the base.

The lid can be removed with the aid of a tool, and can be assembled on either side of the box.

The lid has a stainless steel design surface finish.

ACCESSORIES



GW 24 622

METAL CASING

Code	Suitable for outlet boxes	Pack Carton
GW 24 621	GW24601, GW24611, GW24606, GW24616	1
GW 24 622	GW24602, GW24612, GW24607, GW24617	1

NOTES: suitable for the laying of the underfloor outlet boxes in cast flooring. Supplied with coupling flanges for conduits and channels. With lid.



GW 24 633

KIT FOR INSTALLATION OF DEVICES ON DIN RAIL

Code	Suitable for outlet boxes	Pack Carton
GW 24 633	GW24601, GW24611, GW24602, GW24612	1/30

CHARACTERISTICS: suitable for the installation of DIN rail devices - max. 2 modules, only for underfloor outlet boxes with supports positioned vertically.

NOTES: the kit includes a DIN rail to be fixed on the back-mounting box of the underfloor outlet box, along with a plastic covering support.

FLUSH-MOUNTING BOXES FOR MASONRY WALLS

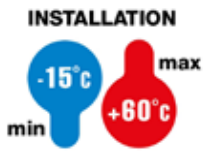

GWT
650°C



RECTANGULAR BOXES - BIG BOX

BIG BOX HIGH CAPACITY RECTANGULAR BOXES FOR DOMESTIC, MODULAR AND DOMOTICS RANGES



GW 24 403



Code	Description	Fixing supports axles distance	Compartment pre-arrangement	Outer dim. LxHxD (mm)	Pack Carton
GW 24 403	3 gang	83.5 mm	3	119x80x50	15/345
GW 24 404	4 gang	108.5 mm	4	144x85x50	5/135
GW 24 406	6 gang	100 mm	6	194x90x50	3/36
GW 24 206	6 gang (3+3)	83.5 mm	1	108x124x50	5/150
GW 24 237	8 gang (4+4)	108.5 mm	2	131x129x53	2/24
GW 24 238	12 gang (6+6)	163.5 mm	2	186x132x53	2/24
GW 24 239	18 gang (6+6+6)	163.5 mm	3	186x190x65	2/16

CHARACTERISTICS: GW24403, GW24404 and GW24406 can be combined with a reusable, mortar-proof, protective shield; functional dividers and joint elements. GW24206: suitable for assembly of GW24005 self-supporting "Compact" plates and GW24215 - GW24216 blank "Compact" plates.

ACCESSORIES SUPPLIED: GW24237, GW24238 and GW24239 include functional dividers.

APPLICATIONS: ideal for use in the Home6Building Automation.

NOTES: GW24239 for PLAYBUS range only.

MORTAR-PROOF PROTECTIVE SHIELDS FOR BIG BOX RECTANGULAR BOXES



GW 24 403 P



Code	For BIG BOX boxes	Pack Carton
GW 24 403 P	GW24403	200
GW 24 404 P	GW24404	50
GW 24 406 P	GW24406	50

CHARACTERISTICS: in technopolymer. Total protection during brick wall work, painting and finishing operations.

Equipped with soft technopolymer antennas for identification purposes, and a central handle making it easier to pull it out.

NOTES: clip fixing to speed up assembly and removal operations.

FUNCTIONAL DIVIDER FOR RECTANGULAR BOXES



GW 24 321

Code	For BIG BOX boxes	For GREEN WALL boxes	Pack Carton
GW 24 321	GW24403, GW24404, GW24406	GW24403PM, GW24404PM, GW24406PM	200

APPLICATIONS: to separate circuits of different voltages in accordance with Systems Standard IEC 60364 (international) and HD 384 (european).



GW 24 330

CONNECTION ELEMENT FOR THE COMBINED ASSEMBLY OF BIG BOX RECTANGULAR BOXES



Code	For BIG BOX boxes	Pack Carton
GW 24 330	GW24403, GW24404, GW24406	150

APPLICATIONS: for the horizontal/vertical composition of BIG BOXes with 3/4/6 gangs.

NOTES: GW24330 allows the assembly of System, Playbus and Chorus plates.

SQUARE BOX



GW 24 231

MODULAR SQUARE BOX



Code	Description	Fixing supports axles distance	Outer dim. LxHxD (mm)	Pack Carton
GW 24 231	2 gang sectional	60 mm	70x70x50	5/200

CHARACTERISTICS: fitted for multiple horizontal/vertical configurations, with centre distance 71 mm between the boxes. Supplied with 2 fixing screws.

ROUND BOXES



GW 24 232

ROUND MODULAR BOXES Ø 60MM WITH COLUMNS FOR THE FIXING SCREWS



Code	Description	Fixing supports axes distance	Dimensions (mm)	Pack Carton
GW 24 232	Modular round	60 mm	Ø 60 x 42	5/200
GW 24 233	Base/unit spacer for coupling at 91 mm			20/200

CHARACTERISTICS: GW24232, fitted for single or double installation, with centre distance composition of 71mm (or 91mm with the special spacer available as an accessory). Supplied with 2 fixing screws.



GW 24 208

ROUND BOXES



Code	Description	Dimensions (mm)	Pack Carton
GW 24 208	Conical	Ø 60 x 46	270
GW 24 209	Cylindrical	Ø 65x38	312
GW 24 210	Cylindrical	Ø 85x42	152

TELEPHONE SYSTEMS BOX



GW 24 221

TELEPHONE SYSTEMS BOX - IVORY COLOUR LID

Code	Type of installation	Outer dim. LxHxD (mm)	Pack Carton
GW 24 221	Conventional	68x68x30	280

CHARACTERISTICS: entries for conduits Ø 20 mm.

WALL-MOUNTING BOXES

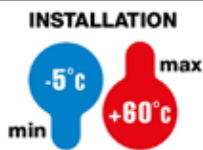

GWT
650°C

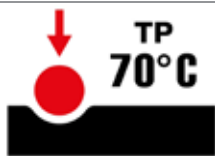

BOXES FOR CHORUS RANGE



GW 16 743

WALL-MOUNTING BOXES FOR MINI-TRUNKING AND TRUNKING USED AS SKIRTING FOR ONE PLATES

Code	Description	Support	Outer dim. LxHxD (mm)	Pack Carton
Colour: White				
GW 16 743	3 gang	GW16803	118x90x46	3/60
GW 16 744	4 gang	GW16804	140x90x46	1/30
Colour: Black				
GW 16 773	3 gang	GW16803	118x90x46	3/30
GW 16 774	4 gang	GW16804	140x90x46	1/30

CHARACTERISTICS: support and plate not included. Use ONE plates (interchangeability with the entire colour range of plates). Pre-arranged for mini-trunking with dimensions BxH (mm): 15x8, 15x10, 22x10, 30x15.

NOTES: fitted for fixing the earth terminal GW26407.



GW 16 752

WALL-MOUNTING BOXES FOR MINI-TRUNKING AND TRUNKING USED AS SKIRTING FOR ONE INTERNATIONAL PLATES

Code	Description	Type	Support	Outer dim. LxHxD (mm)	Pack Carton
Colour: White					
GW 16 752	2 gang		GW16822	90x90x46	1/30
GW 16 753	2+2 gang	Horizontal	GW16822	161x90x46	1/15
GW 16 754	2+2 gang	Vertical	GW16822	90x161x46	1/15
Colour: Black					
GW 16 782	2 gang		GW16822	90x90x46	1/30
GW 16 783	2+2 gang	Horizontal	GW16822	161x90x46	1/15
GW 16 784	2+2 gang	Vertical	GW16822	90x161x46	1/15

CHARACTERISTICS: support and plate not included. Use ONE International plates (interchangeability with the entire colour range of the plates).

Pre-arranged for mini-trunking with dimensions BxH (mm): 15x15, 20x20, 22x10, 30x10, 30x15, 35x15, 45x15.

GW16754 and GW16784 to be used together with plates with a centre distance of 71mm.

GW16752 - GW16782 supplied with 2 fixing screws. GW16753 - GW16754 - GW16783 - GW16784 supplied with 6 fixing screws.

NOTES: fitted for fixing the earth terminal GW26407.

SYSTEM RANGE BOXES



GW 22 471

WALL-MOUNTING BOXES FOR TOP SYSTEM PLATES

Code	Suitable for	Colour	For trunking dim. (mm)	For conduits max Ø (mm)	Pack Carton
GW 22 471	1/2/3 gang TOP SYSTEM	Cloud white	14x8.5 30x13 20x10	16 - 20	3/60
GW 22 472	4 gang TOP SYSTEM	Cloud white	14x8.5 30x13 20x10	16 - 20	3/30

CHARACTERISTICS: fitted for fixing the earth terminal GW26407.



GW 24 006

WALL-MOUNTING BOXES FOR COMPACT SELF-SUPPORTING PLATES



Code	Suitable for	Colour	For trunking dim. (mm)	For conduits max Ø (mm)	Pack Carton
GW 24 006	1/2/3 gang COMPACT	Cloud white	14x8.5 30x13 20x10	16 - 20 - 25	3/60
GW 24 007	3+3 gang COMPACT	Cloud white	14x8.5 30x13 20x10	16 - 20 - 25	3/30

CHARACTERISTICS: fitted for fixing the earth terminal GW26407.



GW 32 431

WALL-MOUNTING BOXES FOR VIRNA PLATES



Code	Suitable for plates	Colour	For trunking dim. (mm)	For conduits max Ø (mm)	Pack Carton
GW 32 431	1/2/3 gangs	Cloud white	15x17 / 22x10 / 25x17	16 - 20	3/60
GW 32 432	1/2/3 gangs	Toner black	15x17 / 22x10 / 25x17	16 - 20	3/60

CHARACTERISTICS: fitted for fixing the earth terminal GW26407.

PLAYBUS RANGE BOXES



GW 32 431

WALL-MOUNTING BOXES



Code	Suitable for	Colour	Pack Carton
GW 32 431	1/2/3 gang PLAYBUS	Cloud white	3/60
GW 32 432	1/2/3 gang PLAYBUS	Toner black	3/60

CHARACTERISTICS: fitted for fixing the earth terminal GW26407. Suitable for conduit Ø 16 - 20 mm.

COMPLEMENTARY ITEMS



GW 24 322

FUNCTIONAL DIVIDERS IN METAL FOR MODULAR, FLUSH-MOUNTING CONTAINERS

Code	Suitable for	Pack Carton
GW 24 322	GW24237	10/100
GW 24 323	GW24238	10/100
GW 24 324	GW24239	10/100

APPLICATIONS: energy separation - signal / separation special circuits.



GW 24 227

DEEP LIDS FOR 3-GANG FLUSH-MOUNTING RECTANGULAR BOXES TO INTERFACE BETWEEN WALL AND FLUSH INSTALLATIONS - IP40

Code	Description	Colour	Pack Carton
GW 24 227	Blank lid	Cloud white	5/50
GW 24 228	Device frame	Cloud white	5/50

APPLICATIONS: the deep lids allow the system to be extended, deriving additional points for drawing and controlling power from a 3 gang flush-mounting rectangular box.

The version with a window, GW24228, permits installing frames and plates with up to 3 gang.

CHARACTERISTICS: for trunking, 15x17 - 22x10 - 25x17mm.



GW 24 211

BLANK PLATES FOR RECTANGULAR FLUSH-MOUNTING BOXES



Code	Description	Configuration	Fixing	Colour	Pack Carton
GW 24 211	3 gang		With screw	Cloud white	1/120
GW 24 212	3 gang		With screw	Toner black	1/120
GW 24 213	4 gang		With screw	Cloud white	1/60
GW 24 214	4 gang		With screw	Toner black	1/60
GW 24 215	3+3 gang	Overlapping	With screw	Cloud white	1/60
GW 24 216	3+3 gang	Overlapping	With screw	Toner black	1/60



GW 24 218

LIDS FOR ROUND FLUSH-MOUNTING BOXES

Code	Description	Colour	Fixing	Pack Carton
GW 24 218	Ø 65mm	White RAL 9016	With fixing clutches	50/400
GW 24 220	Ø 85mm	White	With fixing clutches	50/600

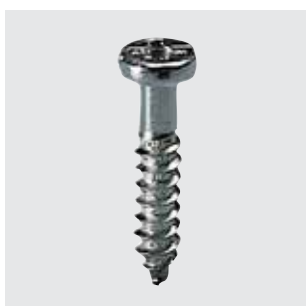

GW 24 224

SPECIAL SELF-TAPPING SCREWS FOR FIXING THE SUPPORTS AND COMPACT SELF-SUPPORTING PLATES

Code	Dimensions (mm)	Suitable for	Pack Carton
GW 24 224	TC 3.5x17	Wood, plastic, aluminium	500/7000
GW 24 225	TC 3.5x30	Deep-mounted boxes	300/4200
GW 24 229	TC 3.5x50	Deep-mounted boxes	300/4200

24 SC



BOXES FOR BRICK WALL APPLICATIONS

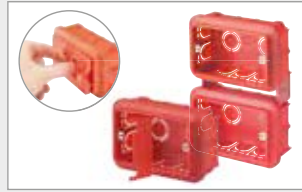

The BIG BOX high-capacity, robust boxes are ideal for both traditional and domestic applications. Unlike conventional products, they offer more internal space and a multitude of accessories. (mortar guard shield, joint elements, dividers, etc.).

BOXES FOR UNDERFLOOR APPLICATIONS



The range meets the increasing needs of protection, connectivity and power take-off in the commercial sector: It includes versions with 10/20 or 16/32 System modules, with a trafficable lid (hollow or stainless steel finish). Thanks to the metal casings, installation is also possible in cast flooring.

BOXES FOR SURFACE APPLICATIONS



With a design purposely coordinated with that of the GEWISS domestic range plates, the wall-mounting boxes for the Chorus, System and Playbus lines, facilitate quality installation even in environments where it is impossible to make chased systems.

UNDERFLOOR OUTLET BOXES

TECHNICAL CHARACTERISTICS

Standard: IEC EN 606070-1 (CEI 23-48); IEC EN 60670-23; IEC EN 60670-24 (CEI 23-49) (*)

Degree of protection: IP52 between the edge of the underfloor box and the floor
IP40 between the lid and the interior of the box (excluding the exit point of the cables)
IP20 in the point of exit of the cables

Installation temperature: Max +45°C; Min -5°C

Material: GW PLAST technopolymer, halogen-free in accordance with EN 60754-2 (CEI EN 50267-2-2)

Point load resistance: 500N

Distributed load resistance: 1000N

Resistance to abnormal heat and fire: Glow wire test 850°C

Dimension tables

UNDERFLOOR OUTLET BOXES

10 modules

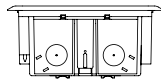
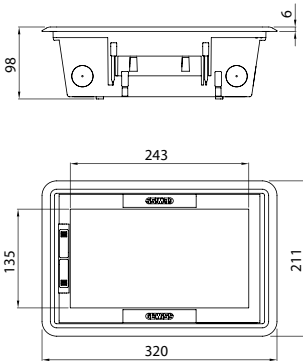

10 modules

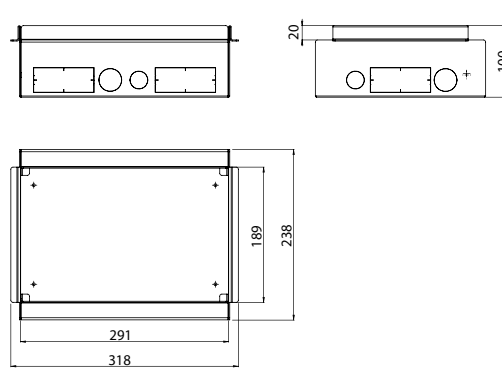

20 modules

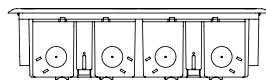
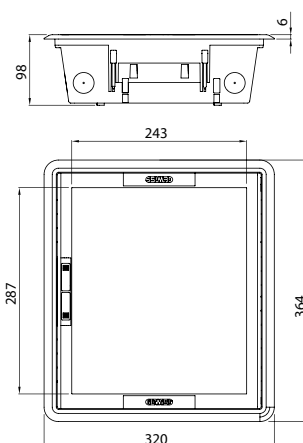

20 modules

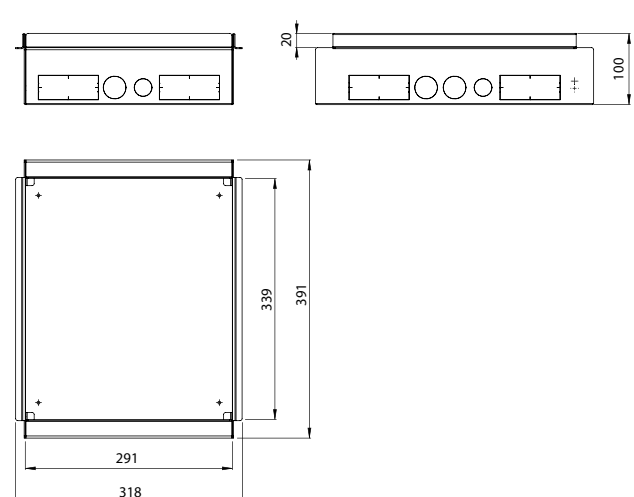

FLUSH-MOUNTING BOXES FOR MASONRY WALLS

TECHNICAL CHARACTERISTICS

Standard: IEC 60670-1; EN 60670-1;

Degree of protection: IP40

Installation temperature: max. +60°C; min. -15°C

Material: GW PLAST technopolymer, halogen-free in accordance with EN 60754-2 (CEI EN 50267-2-2)

Impact resistance: IK 07

Heat resistance: thermo-pressure with ball 70°C

Resistance to abnormal heat and fire: Glow wire test 650°C

Installation: for masonry walls

BEHAVIOUR WITH CHEMICAL AND ATMOSPHERIC AGENTS

Saline solution	Acids		Bases		Solvents				Mineral oil	UV rays
	Concentrated	Diluted	Concentrated	Diluted	Hexane	Benzol	Acetone	Ethyl alcohol		
Resistant	Not resistant	Not resistant	Limited resistance	Limited resistance	Not resistant	Not resistant	Not resistant	Limited resistance	Limited resistance	Limited resistance

Dimension tables

FLUSH-MOUNTING BOXES

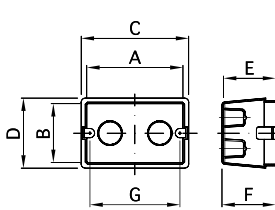

3 gang GW 24 403
4 gang GW 24 404

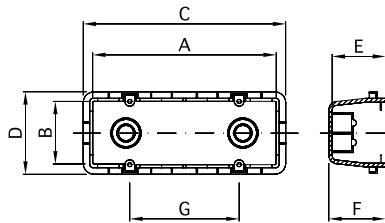

6 gang GW 24 406

Code	GW 24 403	GW 24 404	GW 24 406
	3 gang BIG BOX	4 gang BIG BOX	6 gang BIG BOX
A	96	121	171
B	58	58	60
C	119	144	194
D	80	85	90
E	49	49	49
F	50.5	50.5	50.5
G	83.5	108.5	100

6 gang GW 24 206

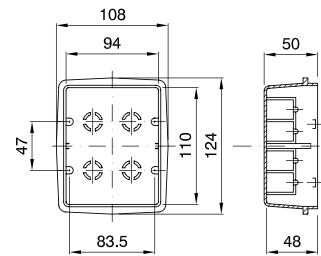

8 gang GW 24 237

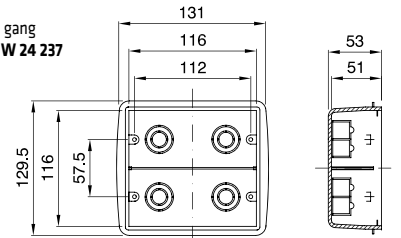

12 gang GW 24 238

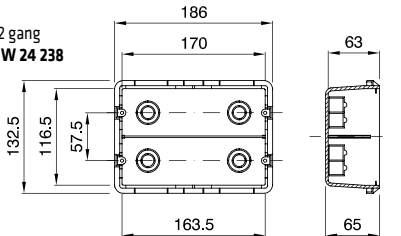

18 gang GW 24 239

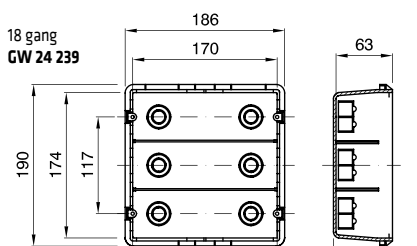

ROUND GW 24 232

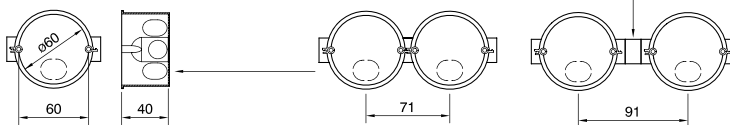

SQUARE GW 24 231

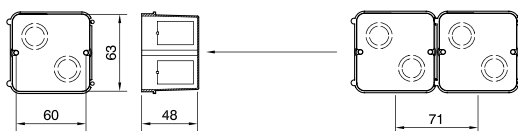

PLAYBUS WALL-MOUNTING BOXES

GW 32 431 - GW 32 432
GW 32 436 - GW 32 437

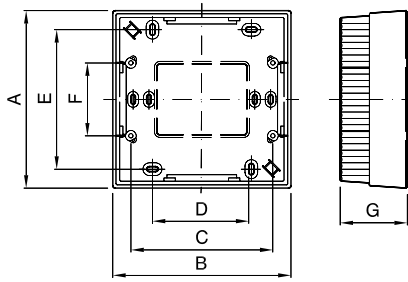

Code	GW 32 431 GW 32 432	GW 32 436 GW 32 437
	3 GANG	4+4 GANG
A	80	140
B	116	140.6
C	83.5	108.5
D	90	78
E	50	110
F	-	57.5
G	50	53

COMPACT WALL-MOUNTING BOXES

GW 24 006
GW 24 007

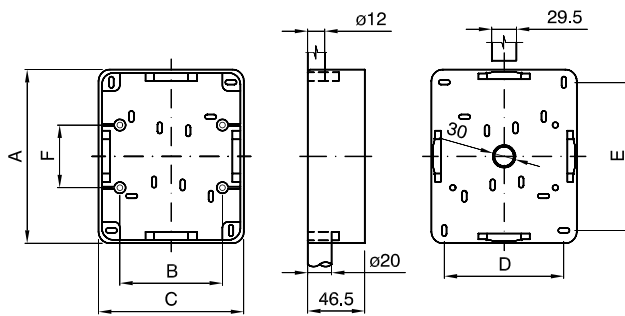

Code	GW 24 006	GW 24 007
	3 GANG	3+3 GANG
A	83	136
B	83.5	83.5
C	113	113
D	96	96
E	65	119
F	-	51

DEEP LIDS

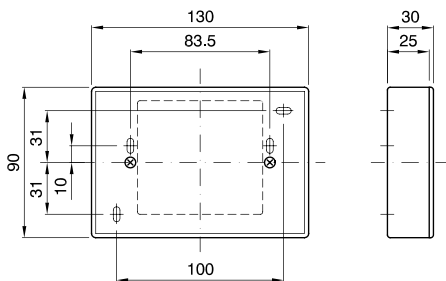

GW 24 227
GW 24 228

TOP SYSTEM WALL-MOUNTING BOXES

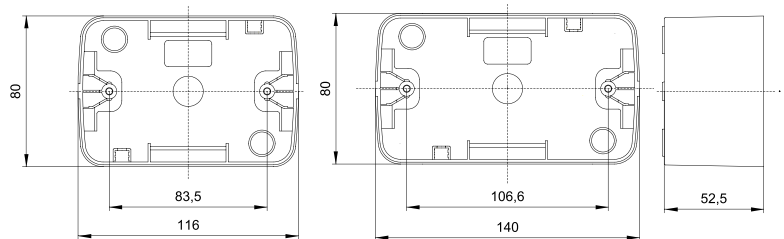

GW 22 471

GW 22 472

BLANK PLATES

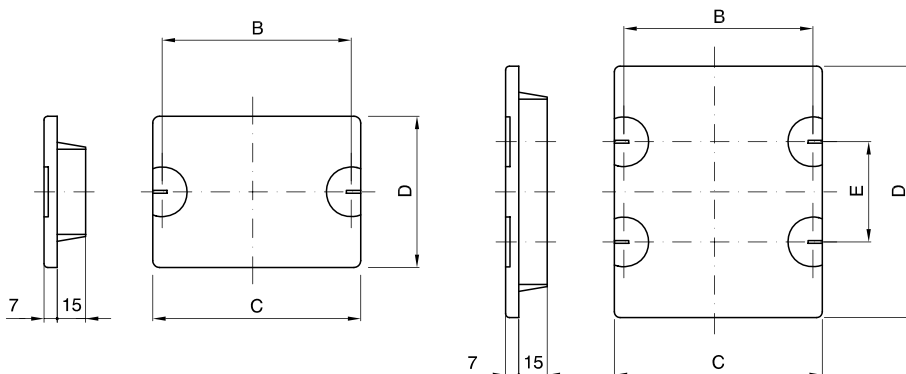

GW 24 211 - GW 24 212
GW 24 213 - GW 24 214

GW 24 215 - GW 24 216

Code	GW 24 211 GW 24 212	GW 24 213 GW 24 214	GW 24 215 GW 24 216
	3 GANG	4 GANG	3+3 GANG
B	83.5	108.5	83.5
C	110	134	110
D	80	80	133
E	-	-	51