

Connectors for structured wiring

RJ45 connectors in categories 5e and 6, shielded and unshielded for data transmission. They allow network connection of information technology devices (computers, printers, modem, etc.) and the connection of multimedia devices (e.g. those used for video conferences). They can also be used for traditional, centralised telephone systems.

Reference standards: EN 50 173 - ISO 11801 - EIA / TIA 568A

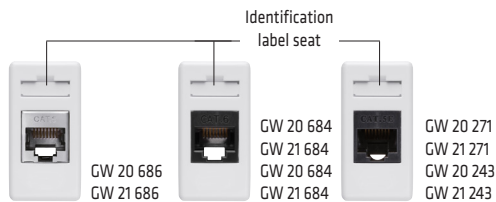

TECHNICAL DATA	GW 20 686 GW 21 686	GW 20 684 - GW 21 684 GW 20 685 - GW 21 685	GW 20 243 GW 21 243	GW 20 271 GW 21 271
Connector type	RJ45			
Type of usable cables	FTP	UTP	FTP	UTP
Number of contacts	8			
Terminals	insulation displacement connection (without the need for tools)			
Category	Cat. 6		Cat. 5e	
Usable transmission protocols	EIA / TIA 568A - EIA / TIA 568B			

Diagrams

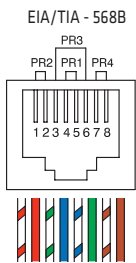
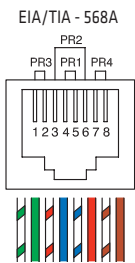

To achieve the EIA/TIA 568A or 568B configuration shown alongside, follow the colour code given on the terminal board (see below).

Quick wiring system

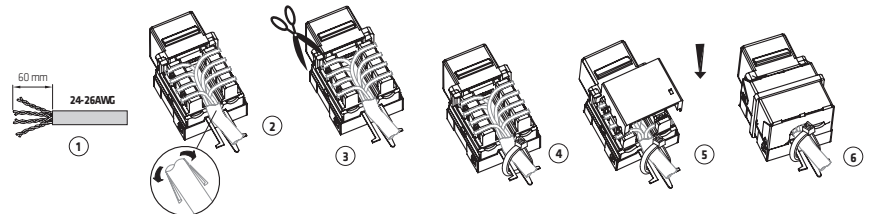

GW 20 243 - GW 21 243
GW 20 686 - GW 21 686

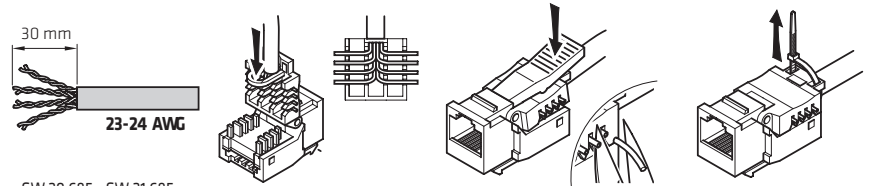

GW 20 685 - GW 21 685

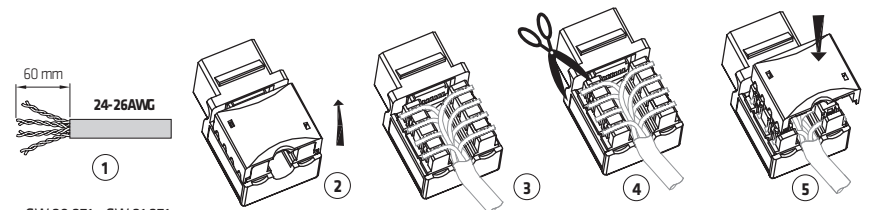

GW 20 271 - GW 21 271
GW 20 684 - GW 21 684

Adapters for structured wiring

A data transmission system with structured wiring offers flexibility of use, installation of the final and universal network, commissioning independent of the location and use of the terminal outputs. In complex and extensive systems (e.g. tenders) the client requires a certificate of conformity for the entire system. Leading companies in the field of structured wiring, installed directly or by qualified operators, are able to provide this service. GEWISS, offering a shell which is compatible with IBM, Systimax/Commscope and AMP/Keystone Jack makes it possible to integrate the PLAYBUS / SYSTEM ranges with data transmission components belonging to a structured system.