

TECHNICAL DRAWING

130
Tee 90°, equal
ISO B1

gebo[®]
fittings

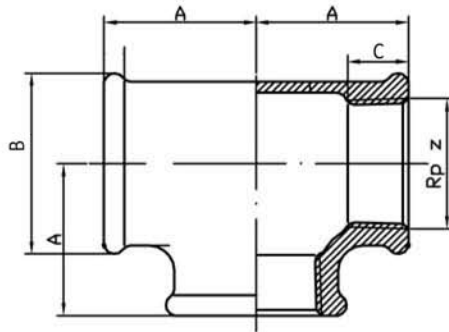

SIZE	A	B	C	Rp z
1 1/2"	50	59	19	1 1/2"
2"	58	72.5	24	2"
2 1/2"	69	89	27	2 1/2"
3"	78	103.5	30	3"
4"	96	130.5	36	4"
5"	115	158	38	5"
6"	131	184	38	6"

TECHNICAL REQUIREMENT:

1. DIMENSION TOLERANCE ACCORDING TO EN10242
2. THREADS ACCORDING TO ISO7/1
3. MATERIAL ACCORDING TO EN 1562
4. HOT DIPPED GALVANIZED SHALL BE IN ACCORDANCE WITH EN ISO 1460